

# AMERICAN MOTORS PARTS CATALOG

## GROUP 5 CLUTCH

DESCRIPTION	GROUP AND FIGURE NO.	GROUP NO.
BEAM ASSEMBLY, Clutch .....	5-3 .....	5.175
BOOT, Clutch Throwout Lever (Shield, Dirt) .....	5-1 .....	5.125
BRACKET, Clutch Release Idler Lever or Beam Pivot .....	5-3, 5-4 .....	5.178
BUSHING, Clutch Pedal .....	5-4 .....	5.135
CUSHION, Clutch Pedal Stop Sponge Rubber .....	5-4 .....	5.164
COVER, Clutch .....	5-1 .....	5.005
COVER, Clutch Pedal Pad .....	5-4, 5-5 .....	5.144
COVER ASSEMBLY, Clutch .....	5-1 .....	5.001
END, Beam or Lever Rod .....	5-3, 5-4 .....	5.187
EYEBOLT, Clutch Pressure .....	5-1 .....	5.018
FULCRUM, Clutch Pressure Lever .....	5-1 .....	5.022
HOUSING, Clutch .....	5-1 .....	5.054
INSULATOR, Beam to Bracket .....	5-3 .....	5.178
LEVER, Clutch Pressure .....	5-1 .....	5.014
LEVER, Clutch Release Idler Inner .....	5-4 .....	5.170
LEVER, Clutch Release Idler Outer .....	5-4 .....	5.168
LEVER, Clutch Throwout .....	5-1, 5-3 .....	5.123
PEDAL, Clutch .....	5-4, 5-5 .....	5.135
PIN, Clutch Pressure Eyebolt .....	5-1 .....	5.018
PIN, Throwout Lever Rod Clevis .....	5-4 .....	5.187
PIN KIT, Pivot .....	5-3 .....	5.175
PIVOT, Clutch Release Idler Inner Lever .....	5-4 .....	5.170
PIVOT, Clutch Release Idler Outer Lever .....	5-4 .....	5.168
PIVOT, Clutch Throwout Lever .....	5-1 .....	5.130
PLATE, Clutch Beam Fulcrum .....	.....	5.181
PLATE, Clutch Driven .....	5-1 .....	5.040
PLATE, Clutch Pressure .....	5-1 .....	5.030
PLATE, Support to Bracket .....	5-3, 5-4 .....	5.178
RETAINER, Clutch Pedal Rod Seal .....	5-4 .....	5.162
RETAINER, Clutch Throwout Lever Boot .....	5-1 .....	5.125
ROD, Clutch Inner Lever or Beam to Throwout Lever .....	5-3, 5-4 .....	5.187
ROD, Clutch Pedal .....	5-5 .....	5.140
ROD, Clutch Pedal to Outer Lever or Beam .....	5-3, 5-4, 5-5 .....	5.160
SCREW, Clutch Cover To Flywheel .....	5-1 .....	5.050
SEAL, Beam or Lever Rod .....	5-3, 5-4 .....	5.187
SEAL, Clutch Pedal or Rod Opening .....	5-4 .....	5.162
SHAFT, Clutch Pedal .....	5-4, 5-5 .....	5.148
SHIELD, Clutch Throwout Lever Dirt (Boot) .....	5-1 .....	5.125
SLEEVE, Clutch Throwout Bearing .....	5-1 .....	5.109
SPACER, Clutch Housing to Engine .....	5-1 .....	5.065
SPRING, Clutch Beam Pull Back .....	5-3 .....	5.184
SPRING, Clutch Pedal Pull Back .....	5-3 .....	5.150
SPRING, Clutch Pedal Shaft .....	5-5 .....	5.148
SPRING, Clutch Pressure Lever Anti-Rattle .....	5-1 .....	5.026
SPRING, Clutch Release Idler Lever .....	5-4 .....	5.172
SPRING, Clutch Throwout Lever (In Clutch) .....	5-1 .....	5.132
SPRING, Clutch Throwout Lever .....	5-3, 5-4 .....	5.190
SPRING SET, Clutch .....	5-1 .....	5.035
SUPPORT, Clutch Pedal .....	.....	5.152
SUPPORT, Clutch Release Idler Lever or Beam Pivot .....	5-4 .....	5.178



# AMERICAN MOTORS PARTS CATALOG

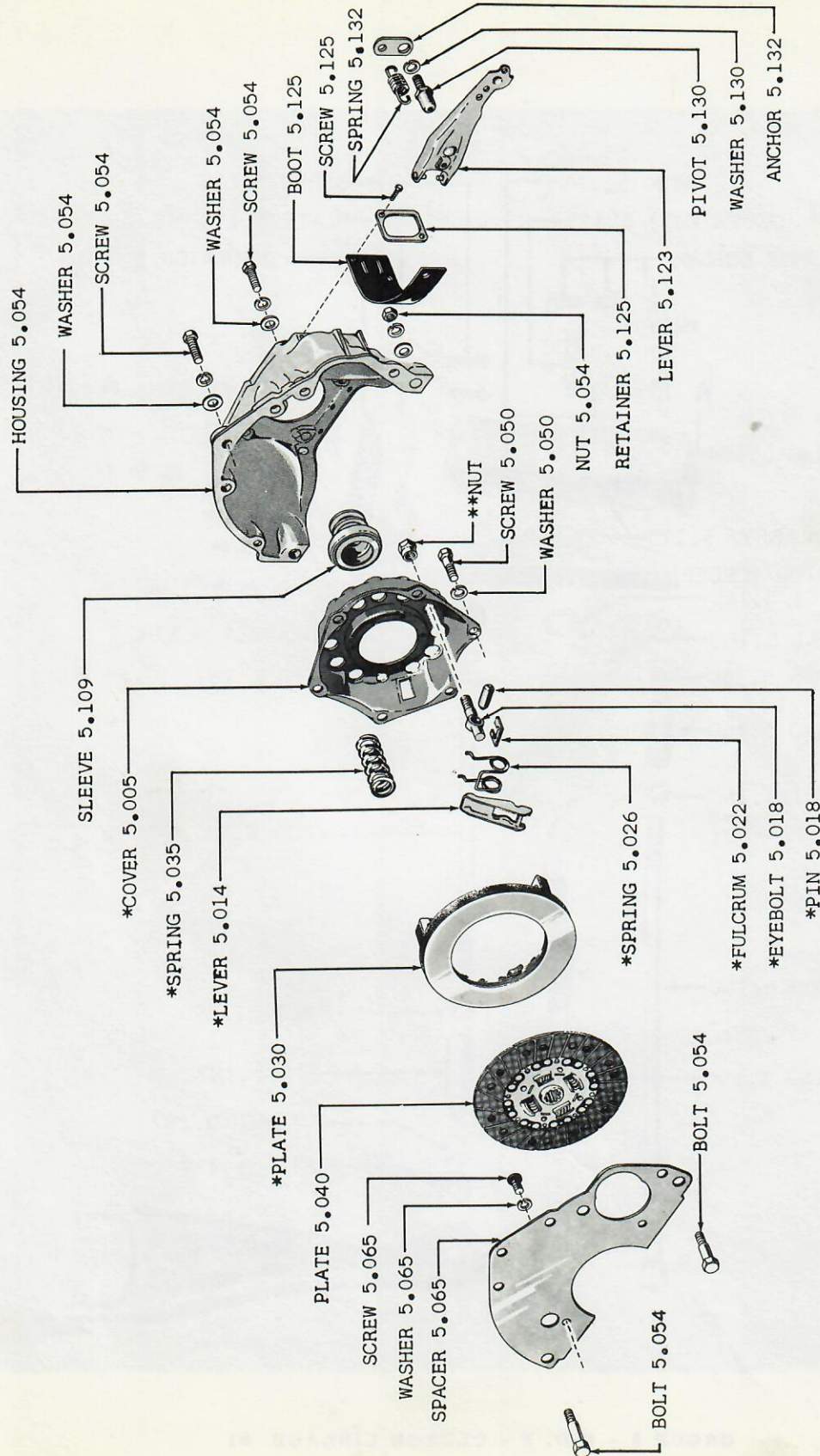

\* ALSO SERVICED AS PART OF COVER ASSY. 5.001

\*\* SERVICED ONLY AS PART OF EYEBOLT 5.018 AND COVER ASSY. 5.001

GROUP 5 - FIG. 1 - CLUTCH COVER AND HOUSING 01-10-20-80



# AMERICAN MOTORS PARTS CATALOG

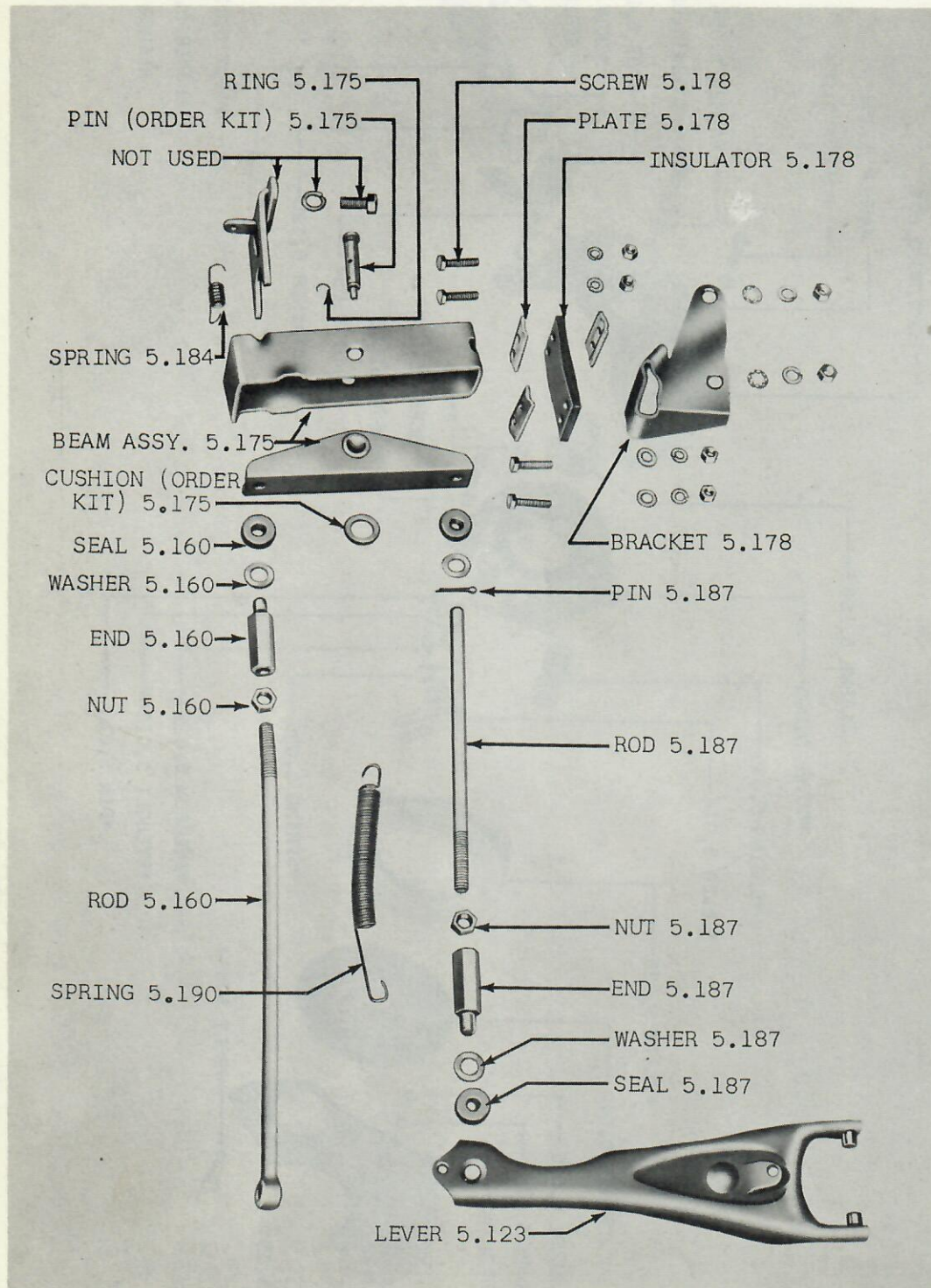

GROUP 5 - FIG. 3 - CLUTCH LINKAGE 01



# AMERICAN MOTORS PARTS CATALOG

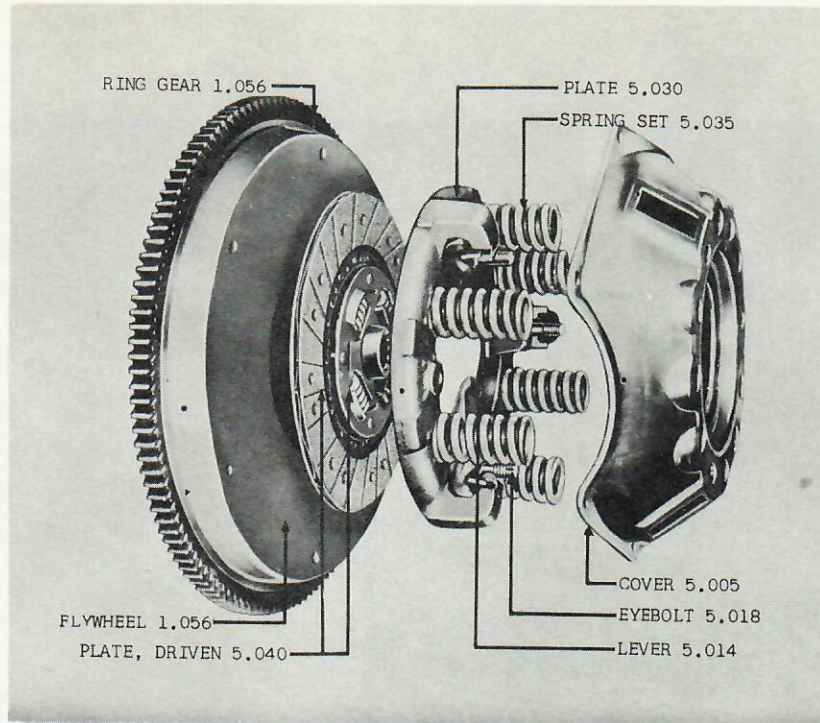

GROUP 5 - FIG. 1 - CLUTCH COVER ASSEMBLY 01

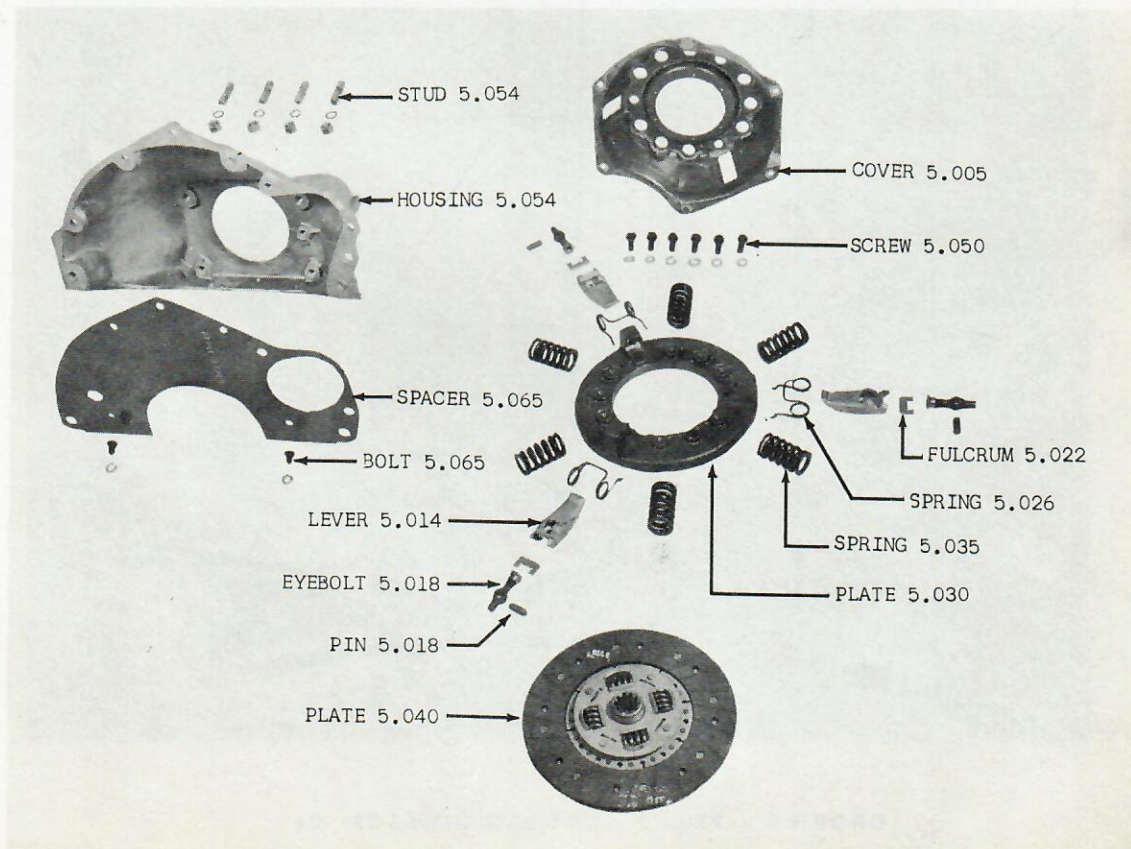

GROUP 5 - FIG. 2 - CLUTCH COVER AND HOUSING 10-20-80



# AMERICAN MOTORS PARTS CATALOG

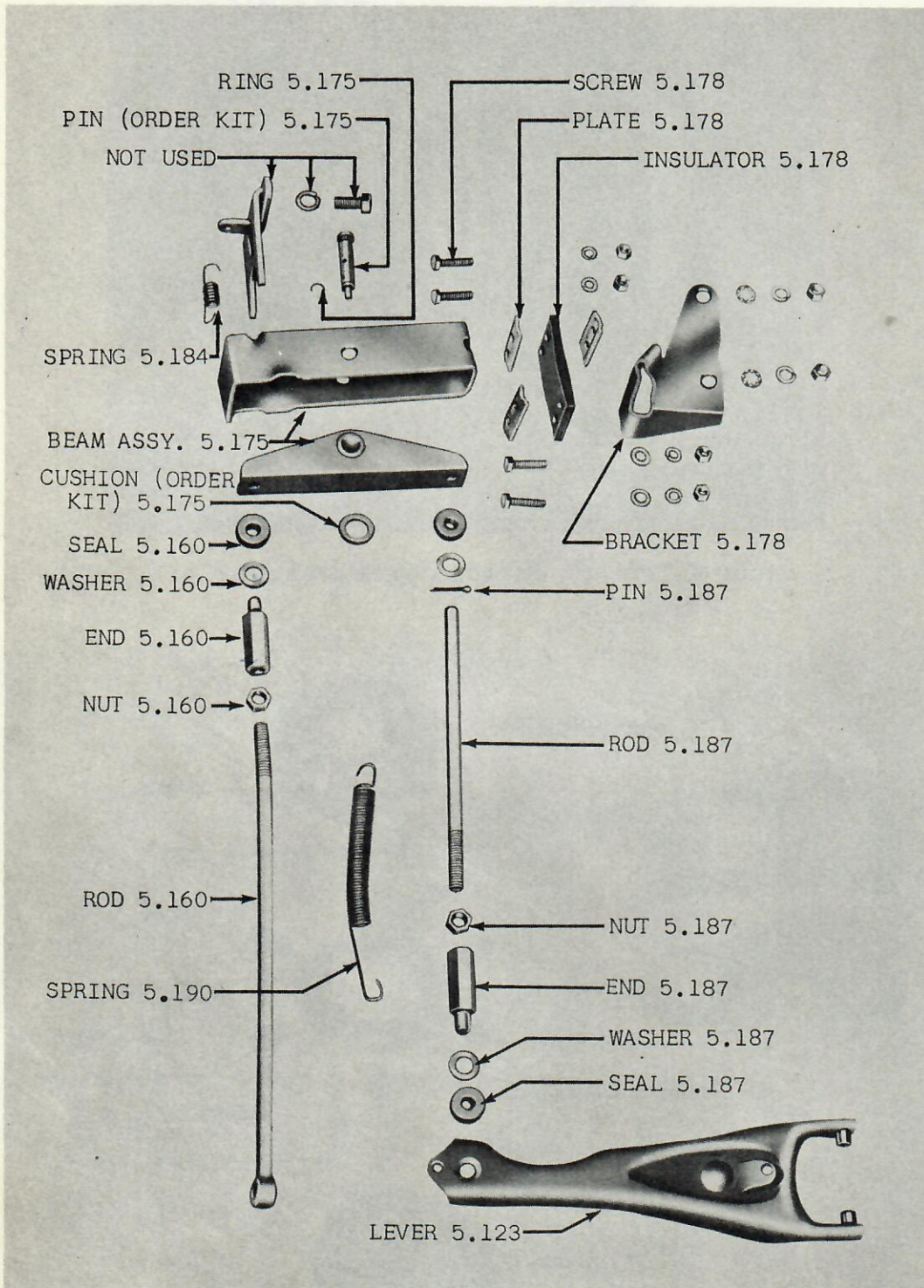

GROUP 5 - FIG. 3 - CLUTCH LINKAGE 01



# AMERICAN MOTORS PARTS CATALOG

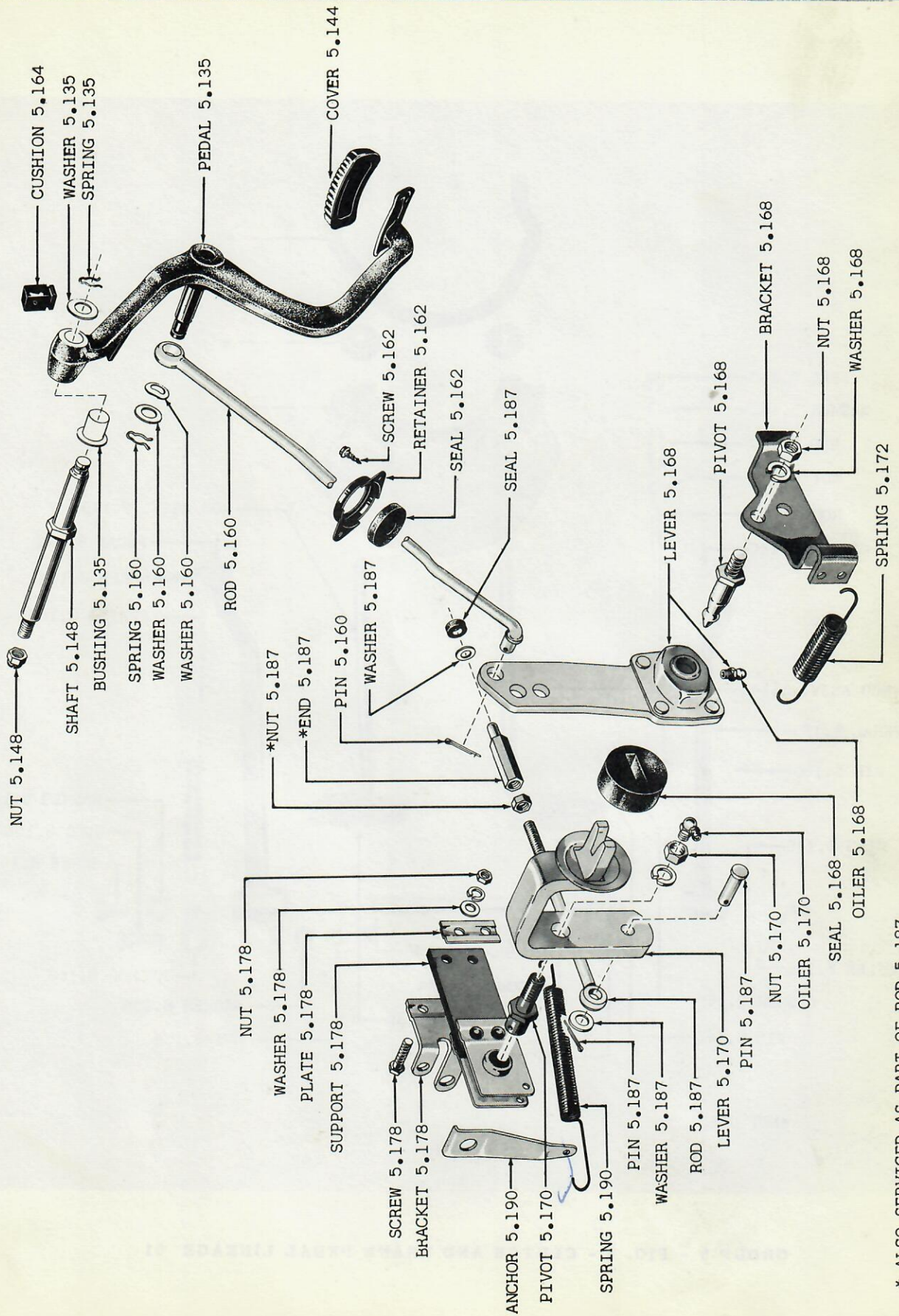

\* ALSO SERVICED AS PART OF ROD 5.187

GROUP 5 - FIG. 4 - CLUTCH PEDAL AND LINKAGE 10-20-80



# AMERICAN MOTORS PARTS CATALOG

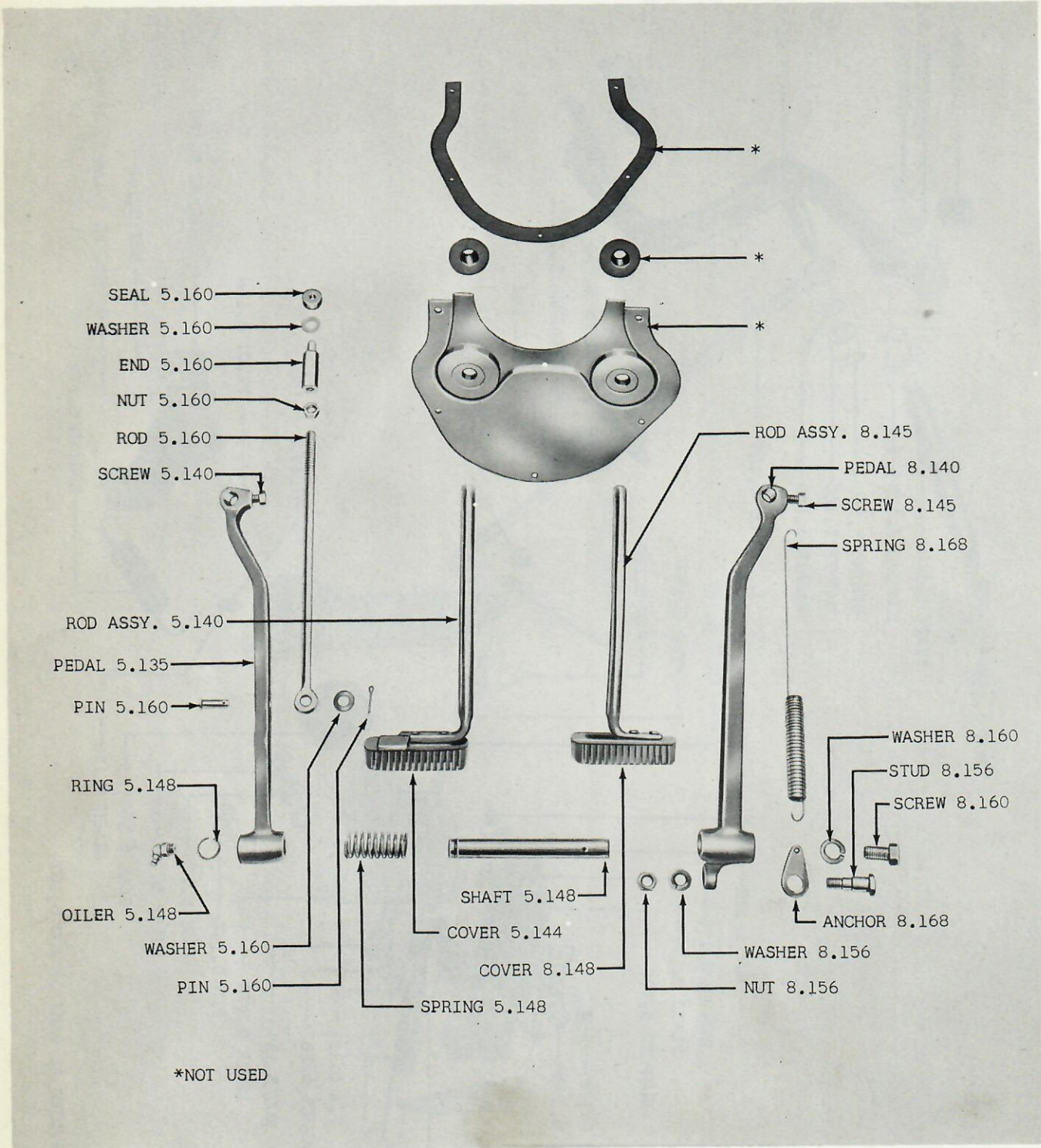

GROUP 5 - FIG. 5 - CLUTCH AND BRAKE PEDAL LINKAGE 01



# AMERICAN MOTORS PARTS CATALOG

5.026

DESCRIPTION	YEAR AND MODEL	PER CAR	PART NO.
<b>GROUP 5 CLUTCH</b>			
<b>5.001 COVER ASSEMBLY, Clutch</b>			
COVER ASSEMBLY (Borg & Beck No. 987 On Cover)..	59 01.....	1	312 4416
(Borg & Beck No. 1360 On Cover).	59 01 (Heavy Duty).....	1	313 9078
(Borg & Beck No. 1391 On Cover).	59 10.....	1	314 4938
(Borg & Beck No. 1416 On Cover).	59 10 (Heavy Duty).....	1	314 9162
(Borg & Beck No. 1494 On Cover).	59 10 (WST-Heavy Duty-Note 5.001-1).....	1	315 5760
(Borg & Beck No. 1436 On Cover).	59 20.....	1	314 9824
(Borg & Beck No. 1407 On Cover).	59 20 (Heavy Duty).....	1	314 7551
(Borg & Beck No. 1442 On Cover).	59 80.....	1	315 0450
(Borg & Beck No. 1449 On Cover).	59 80 (Heavy Duty).....	1	315 1514
<b>5.005 COVER, Clutch</b>			
COVER.....	59 01-10.....	1	310 7733
	59 01 (Heavy Duty).....	1	311 6885
	59 10 (WST-Heavy Duty-Note 5.001-1).....	1	307 810
	59 20.....	1	320 0025
	59 20 (Heavy Duty).....	1	93 488
	59 80.....	1	311 8782
<b>5.014 LEVER, Clutch Pressure</b>			
LEVER.....	59 01-10.....	3	310 7730
	59 01 (Heavy Duty).....	3	311 6888
	59 10 (WST-Heavy Duty-Note 5.001-1).....	3	27 989
	59 20-80.....	3	93 489
<b>5.018 EYEBOLT, Clutch Pressure</b>			
EYEBOLT (Incl. Nut).....	59 01-10.....	3	310 7686
	59 01 (Heavy Duty).....	3	311 6887
	59 20.....	3	26 810
	59 80.....	3	311 8939
PIN.....	59 01-10.....	3	310 7731
	59 01 (Heavy Duty): 59 10 (WST-Heavy Duty- Note 5.001-1): 59 20-80.....	3	45 473
<b>5.022 FULCRUM, Clutch Pressure Lever</b>			
FULCRUM.....	59 01-10.....	3	310 7732
	59 01 (Heavy Duty): 59 10 (WST-Heavy Duty- Note 5.001-1): 59 20-80.....	3	46 024
<b>5.026 SPRING, Clutch Pressure Lever Anti-Rattle</b>			
SPRING.....	59 01-10.....	3	310 7734
	59 01 (Heavy Duty).....	3	311 6886
	59 10 (WST-Heavy Duty-Note 5.001-1): 59 20-80	3	46 242

NOTE 5.001-1: 59 10 (WST) cars having a Production Installed Heavy Duty Package may be identified in the following way: The Trunnion at the Transmission end of the Torque Tube is welded, instead of threaded, to the Torque Tube.



# AMERICAN MOTORS PARTS CATALOG

## 5.030 PLATE, Clutch Pressure

PLATE.....	59 01.....	1	310 7728
	59 01 (Heavy Duty).....	1	311 6889
	59 10.....	1	311 9162
	59 10 (WST-Heavy Duty-Note 5.001-1).....	1	310 4831
	59 20.....	1	93 491
	59 80.....	1	311 9156

## 5.035 SPRING SET, Clutch

SPRING SET (Incl. 6 Springs).....	59 01.....	1	310 7729
	59 10.....	1	311 9163
	59 10 (Heavy Duty).....	1	311 9906
	59 20.....	1	320 0026
(Incl. 9 Springs).....	59 01 (Heavy Duty).....	1	310 4834
	59 20 (Heavy Duty).....	1	311 9645
(Incl. 12 Springs).....	59 80.....	1	320 0030
	59 80 (Heavy Duty).....	1	320 0243

## 5.040 PLATE, Clutch Driven

PLATE (Incl. Facings).....	59 01.....	1	314 2241
	59 01 (WST-Heavy Duty).....	1	313 9077
	59 01 (WOD-Heavy Duty): 59 10 (WOD).....	1	314 7133
	59 10 (WST).....	1	314 4937
	59 10 (WST-Heavy Duty-Note 5.001-1).....	1	315 5695
	59 20.....	1	312 5822
	59 20 (Heavy Duty).....	1	314 7552
	59 80.....	1	315 0449

## 5.050 SCREW, Clutch Cover To Flywheel

SCREW.....	59 01-10.....	6	311 0965
	59 20-80.....	6	40 574
WASHER (Lock).....	59 01-10.....	6	G120214
	59 20-80.....	6	G103321

## 5.054 HOUSING, Clutch

HOUSING.....	59 01: 59 10 (LHD).....	1	314 5345
	59 10 (WST-Heavy Duty-Note 5.001-1).....	1	315 5822
	59 10 (RHD).....	1	314 5410
	59 20.....	1	314 5020
	59 80.....	1	315 0098
DOWEL, To Engine.....	59 20.....	2	314 5091
BOLT, To Engine Dowel (2-7/16").....	59 01: 59 10 (RHD).....	2	310 6503
	59 10 (LHD).....	1	310 6503
(2-11/16").....	59 10 (LHD).....	1	314 6593
SCREW, To Engine.....	59 01-10.....	3	G179841
	59 20-80.....	6	G179868
To Transmission Case.....	59 20-80.....	4	G179861
STUD, To Transmission Case.....	59 01-10.....	4	312 7071
WASHER (Plain), To Engine Dowel Bolt.....	59 01-10.....	2	800 0190
To Engine Screw.....	59 01-10.....	3	800 0162
	59 20-80.....	6	800 0299
To Transmission Case Screw.....	59 01-10-20-80.....	1	800 0299



# AMERICAN MOTORS PARTS CATALOG

5.135

(Lock), To Engine Dowel Bolt.....	59 01-10.....	2	G103328
To Engine Screw.....	59 01-10.....	3	G103021
	59 20-80.....	6	G103328
To Transmission Case Screw.....	59 01-10.....	4	G114607
	59 20-80.....	1	G114607
NUT, To Engine Dowel Bolt.....	59 01-10.....	2	G103027
<b>5.065 SPACER, Clutch Housing To Engine</b>			
SPACER.....	59 01-10.....	1	314 5412
	59 20-80.....	1	314 5085
SCREW.....	59 01-10.....	2	313 0284
	59 20-80.....	2	800 0068
WASHER (Lock).....	59 01-10.....	2	G120214
<b>5.109 SLEEVE, Clutch Throwout Lever</b>			
SLEEVE (Incl. Bearing).....	59 01-10.....	1	313 0008
	59 10 (WST-Heavy Duty-Note 5.001-1): 59 20-80	1	314 0867
<b>5.123 LEVER, Clutch Throwout</b>			
LEVER.....	59 01-10.....	1	314 4091
	59 01 (Heavy Duty).....	1	314 5331
	59 10 (WST-Heavy Duty-Note 5.001-1): 59 20-80	1	312 5599
<b>5.125 BOOT, Clutch Throwout Lever</b>			
BOOT (Shield, Dirt).....	59 01: 59 10 (LHD).....	1	313 0098
	59 10 (RHD).....	1	313 5492
	59 10 (WST-Heavy Duty-Note 5.001-1): 59 20-80	1	314 5646
RETAINER.....	59 01: 59 10 (LHD).....	1	312 9614
	59 10 (RHD).....	1	313 2530
	59 10 (WST-Heavy Duty-Note 5.001-1): 59 20-80	1	314 5647
SCREW.....	59 01-10-20-80.....	2	G448423
<b>5.130 PIVOT, Clutch Throwout Lever</b>			
PIVOT (Incl. Wick).....	59 01-10.....	1	311 5569
	59 10 (WST-Heavy Duty-Note 5.001-1): 59 20-80	1	311 5761
WICK.....	59 01-10-20-80.....	1	313 2682
WASHER (Lock).....	59 01-10-20-80.....	1	G103321
<b>5.132 SPRING, Clutch Throwout Lever (In Clutch)</b>			
SPRING.....	59 01-10.....	1	310 6505
	59 10 (WST-Heavy Duty-Note 5.001-1): 59 20-80	1	312 7032
ANCHOR.....	59 01-10-20-80.....	1	310 5508
<b>5.135 PEDAL, Clutch</b>			
PEDAL.....	59 01.....	1	314 0843
	59 10 (LHD): 59 20-80.....	1	315 3017
	59 10 (RHD).....	1	314 6529
BUSHING.....	59 10 (LHD): 59 20-80.....	2	314 5488
OILER.....	59 10 (RHD).....	1	313 0018
WASHER (Plain).....	59 10 (LHD): 59 20-80.....	1	800 0441
SPRING, Retaining.....	59 10 (LHD): 59 20-80.....	1	G455563



## 5.140 ROD, Clutch Pedal

ROD (Note 5.140-1).....	59 01.....	1	315 4088
(Note 5.140-2).....	59 01.....	1	315 7584
	59 10 (RHD).....	1	313 4838
SCREW.....	59 01: 59 10 (RHD).....	1	313 3781

## 5.144 COVER, Clutch Pedal Pad

COVER.....	59 01: 59 10 (RHD).....	1	310 6732
	59 10 (LHD): 59 20-80.....	1	314 8572

## 5.148 SHAFT, Clutch Pedal

SHAFT.....	59 01.....	1	312 9550
	59 10 (LHD): 59 20-80.....	1	314 9728
	59 10 (RHD).....	1	341 0274
NUT.....	59 10 (LHD): 59 20-80.....	1	G442828
BOLT.....	59 01.....	1	G181659
WASHER (Plain).....	59 01.....	1	800 0207
(Lock).....	59 01.....	1	G131100
RING, Lock.....	59 01.....	1	310 6815
OILER.....	59 01.....	1	G273323
SPRING.....	59 01.....	1	312 9696
	59 10-80 (RHD).....	1	314 1453

## 5.152 SUPPORT, Clutch Pedal

SUPPORT.....	59 10 (LHD): 59 20.....	1	315 3011
	59 80.....	1	315 3012
BOLT.....	59 80.....	1	G180120
To Dash Panel.....	59 10-20-80 (LHD).....	4	344 4626
WASHER (Lock).....	59 80.....	1	G120382

## 5.160 ROD, Clutch Pedal To Outer Lever Or Beam

ROD.....	59 10 (LHD)(Note 5.160-1).....	1	315 3018
	59 10 (LHD)(Note 5.160-2).....	1	315 7160
	59 10 (WST-Heavy Duty-Notes 5.001-1 And 5.160-1).....	1	315 5777
	59 10 (WST-Heavy Duty-Notes 5.001-1 And 5.160-2).....	1	315 7166
	59 20 (Note 5.160-1).....	1	315 3019
	59 20 (Note 5.160-2).....	1	315 7161
	59 80 (Note 5.160-1).....	1	315 3020
	59 80 (Note 5.160-2).....	1	315 7162
(Incl. End, Nut And Clevis).....	59 01.....	1	314 0748
	59 10 (RHD).....	1	314 8942
END.....	59 01.....	1	312 2695
	59 10 (RHD).....	1	314 5456
NUT, End.....	59 01: 59 10 (RHD).....	1	G120369
SEAL.....	59 01: 59 10 (RHD).....	1	313 0998

NOTE 5.140-1: On 59 01 used prior to Body No. 46099.

NOTE 5.140-2: On 59 01 used beg. with Body No. 46099.

NOTE 5.160-1: On 59 10 used prior to Serial No. D-536332, beg. with Serial No. D-550001 and prior to Serial No. D-602154; On 59 20 used prior to Serial No. A-32537; On 59 80 used prior to Serial No. V-52793.

NOTE 5.160-2: On 59 10 used beg. with Serial No. D-536332, prior to Serial No. D-550001 and beg. with Serial No. D-602154; On 59 20 used beg. with Serial No. A-32537; On 59 80 used beg. with Serial No. V-52793.



# AMERICAN MOTORS PARTS CATALOG

5.175

PIN, Clevis.....	59 01: 59 10 (RHD).....	1	800 0228
Cotter.....	59 01: 59 10 (RHD).....	1	G103373
	59 10 (LHD): 59 20-80.....	1	G103385
WASHER (Plain)(1/16" Thick).....	59 10 (LHD): 59 20-80.....	1	G120394
(1/32" Thick).....	59 10 (LHD): 59 20-80.....	1	800 0161
Pin.....	59 01: 59 10 (RHD).....	1	800 0163
Clevis Pin.....	59 01: 59 10 (RHD).....	1	800 0163
SPRING, Retaining.....	59 10 (LHD): 59 20-80.....	1	G455563

**5.162 SEAL, Clutch Pedal Or Pedal Opening**

SEAL.....	59 01: 59 10 (RHD).....	1	312 8937
	59 10 (LHD): 59 20-80.....	1	314 6336
RETAINER.....	59 10-20-80.....	1	314 6337
SCREW, Retainer.....	59 10-20-80.....	2	800 0105

**5.164 CUSHION, Clutch Pedal Stop Sponge Rubber**

CUSHION.....	59 10 (LHD)(Note 5.160-1): 59 20-80 (Note 5.160-1).....	1	314 6897
	59 10 (LHD)(Note 5.160-2): 59 20-80 (Note 5.160-2).....	1	314 6763

**5.168 LEVER, Clutch Release Idler Outer**

LEVER (Incl. Bearing And Oiler).....	59 10 (LHD): 59 20-80.....	1	315 3028
SEAL, Oil (Rubber).....	59 10 (LHD): 59 20-80.....	1	315 0475
OILER.....	59 10 (LHD): 59 20-80.....	1	G125696
PIVOT.....	59 10 (LHD): 59 20-80.....	1	315 0477
WASHER (Lock), Pivot.....	59 10 (LHD): 59 20-80.....	1	G131100
NUT, Pivot.....	59 10 (LHD): 59 20-80.....	1	G120370
BRACKET, To Frame.....	59 10 (LHD): 59 20.....	1	341 7155
	59 80.....	1	342 3975

**5.170 LEVER, Clutch Release Idler Inner**

LEVER.....	59 10 (LHD).....	1	315 0484
	59 20.....	1	315 0472
	59 80.....	1	315 3022
OILER.....	59 10 (LHD): 59 20-80.....	1	G271290
PIVOT.....	59 10 (LHD): 59 20-80.....	1	315 2563
WASHER (Lock), Pivot.....	59 10 (LHD): 59 20-80.....	1	G131100
NUT, Pivot.....	59 10 (LHD): 59 20-80.....	1	G120370

**5.172 SPRING, Clutch Release Idler Lever**

SPRING.....	59 10 (LHD).....	1	312 3558
	59 20-80.....	1	315 3025

**5.175 BEAM ASSEMBLY, Clutch**

BEAM ASSEMBLY.....	59 01: 59 10 (RHD).....	1	314 0750
STUD, To Oil Pan.....	59 01 (WST)(WOD).....	2	315 4657
PIN KIT, Pivot (Incl. Pin, Cushion, Oiler And Lock Ring).....	59 01: 59 10 (RHD).....	1	311 4046
RING, Pin Lock.....	59 01: 59 10 (RHD).....	1	312 1737
OILER.....	59 01: 59 10 (RHD).....	1	313 0018



## 5.178 BRACKET - SUPPORT, Clutch Idler Inner Lever Or Beam Pivot

BRACKET, To Engine.....	59 01.....	1	315 4092
	59 10 (LHD).....	1	315 0481
	59 10 (RHD).....	1	314 6543
	59 20-80.....	1	315 0478
SUPPORT.....	59 10 (LHD): 59 20-80.....	1	315 1675
SEAT, Idler Lever Spring.....	59 20-80.....	1	315 3024
INSULATOR, Bracket To Beam.....	59 01.....	1	315 4093
	59 10 (RHD).....	1	314 3230
PLATE, Insulator.....	59 01: 59 10 (RHD).....	3	312 5651
	59 10 (LHD): 59 20-80.....	1	312 5651
SCREW, Support To Bracket.....	59 10 (LHD): 59 20-80.....	2	G180022
Plate (7/8").....	59 01.....	2	G180021
(1").....	59 01.....	2	G180022
	59 10 (RHD).....	4	G180022
BOLT, To Clutch Housing.....	59 20-80.....	2	G180077
WASHER (Plain), Support To Bracket.....	59 10 (LHD): 59 20-80.....	2	G120392
Plate Screw.....	59 10 (RHD).....	2	G120392
(Lock), Support To Bracket.....	59 10 (LHD): 59 20-80.....	2	G120380
Plate Screw.....	59 01: 59 10 (RHD).....	4	G120380
To Engine Stud.....	59 01: 59 10 (RHD).....	2	G120214
To Clutch Housing Bolt.....	59 20-80.....	2	G120214
NUT, Support To Bracket Screw.....	59 10 (LHD): 59 20-80.....	2	G120375
Plate Screw.....	59 01: 59 10 (RHD).....	4	G120375
To Engine Stud.....	59 01: 59 10 (RHD).....	2	G120368

## 5.181 PLATE, Clutch Beam Fulcrum

PLATE.....	59 10 (RHD).....	1	341 0276
------------	------------------	---	----------

## 5.184 SPRING, Clutch Beam Pull Back

SPRING.....	59 01: 59 10 (RHD).....	2	313 3787
-------------	-------------------------	---	----------

## 5.187 ROD, Clutch Inner Lever Or Beam To Throwout Lever

ROD (Incl. End And Nut).....	59 01.....	1	315 4090
	59 10 (LHD).....	1	315 0489
	59 10 (RHD).....	1	314 6634
	59 10 (WST-Heavy Duty-Note 5.001-1).....	1	315 5779
	59 20-80.....	1	315 0487
END.....	59 01.....	1	312 2695
	59 10-20-80.....	1	314 5456
NUT.....	59 01-10-20-80.....	1	G120369
SEAL, To Rod End.....	59 01: 59 10 (RHD).....	2	313 0998
	59 10 (LHD): 59 20-80.....	1	313 0998
WASHER (Plain), End Seal.....	59 01: 59 10 (RHD).....	2	800 0163
	59 10 (LHD): 59 20-80.....	1	800 0163
To Lever.....	59 10 (LHD): 59 20-80.....	1	G120394
PIN, Lever Clevis.....	59 10 (LHD): 59 20-80.....	1	800 0337
To Lever.....	59 01-10-20-80.....	1	G103373

## 5.190 SPRING, Clutch Throwout Lever

SPRING.....	59 01.....	1	312 8205
	59 10 (LHD).....	1	314 6472
	59 10 (RHD).....	1	312 3558
	59 10 (WST-Heavy Duty-Note 5.001-1): 59 20-80.....	1	314 5435
ANCHOR.....	59 10 (LHD).....	1	315 0476
	59 10 (WST-Heavy Duty-Note 5.001-1): 59 20-80.....	1	314 5919